



Salcombe Road, London, N16

BUTLER & STAG



**\*Physical viewings taking place\***  
**Located on the first floor of a sought after period mansion block, quietly positioned between Dalston and Stoke Newington, is this wonderfully bright and contemporary apartment.**



- First Floor
- Wonderfully Bright
- Close To Transport
- Planned Refurbishments
- Spacious Proportions
- Period Mansion Block
- Convenient Location





## First Floor

Approx. 46.9 sq. metres (505.0 sq. feet)

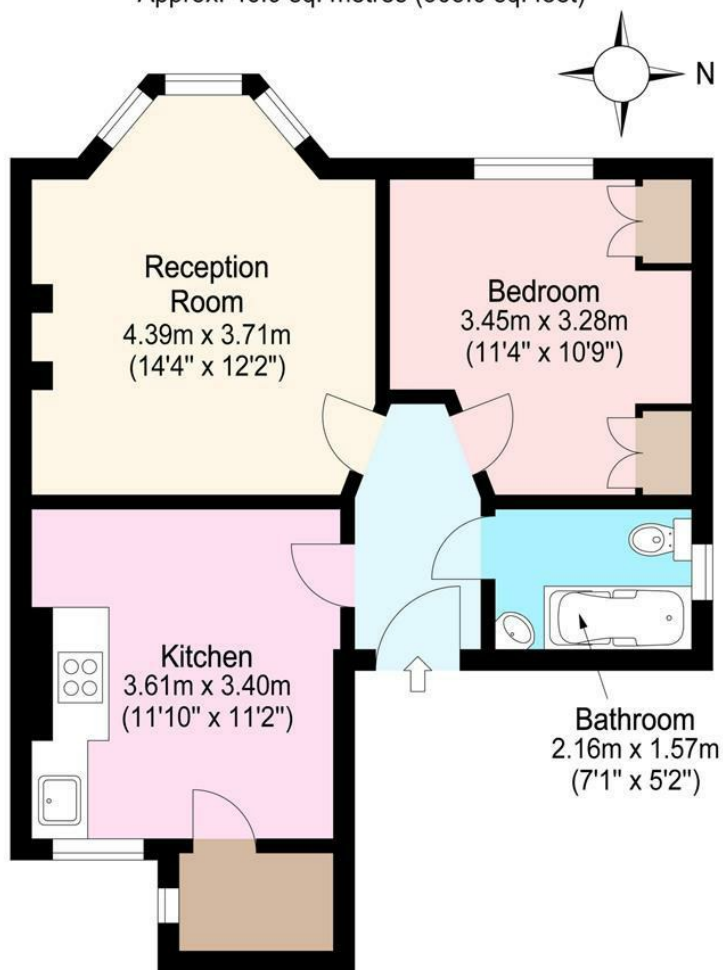

Total area. approx. 46.9 sq. metres (505.0 sq. feet)  
For illustration purposes only - not to scale

IMPORTANT NOTICE - These particulars have been prepared in good faith and they are not intended to constitute part of an offer or contract. We have not performed a structural survey on this property and the services, appliances and specific fittings have not been tested. All photographs, measurements, floor plans and distances referred to are given as a guide and should not be relied upon.

# BUTLER & STAG

☎ 020 8102 1236

🏠 508 Roman Road, Bow, London, E3 5LU

✉ bow@butlerandstag.com

[www.butlerandstag.uk](http://www.butlerandstag.uk)